

# ABF

## DOWNDRAFT BENCH WITH FILTRATION



### Use

Extraction of welding fumes and dust from manual plasma cutting, grinding, sanding, cutting, deburring, polishing

### Construction

Painted steel

### Applications



MIG MAG



Pulse  
MIG MAG



MMA  
Stick  
electrode



PLASMA  
CUTTING



GRINDING

### MAIN FEATURES

ABF is a downdraft bench suited for extraction of fume and dust produced by welding or grinding on workpieces. Extraction is realised both on the worktop and from the rear panel.

Load capacity of the worktop: up to 350 kg/m<sup>2</sup>.

Possibility to remove the side panels to place larger components onto the worktop.

Airtight collector drawer, to gather the dust extracted.

### CONSTRUCTION

Bearing structure in painted steel of suitable thickness. Diaphragm worktop on special guides, available in different versions, according to the specific metalwork process. Mechanical pre-filter in steel mesh. Main filter with high efficiency pockets and high accumulation capacity for small particles and dust.



### APPLICATION

The bench is designed for the extraction of fume and dust generated by non-oily welding processes and small manual thermal cutting operations. Not suited for liquid nor paint.

## FILTRATION

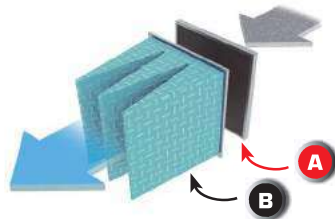
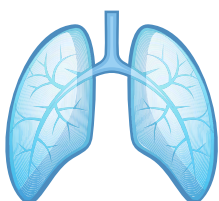
All the filters are tested / certified according to the CEN 779 - EUROVENT 4/4 - CEN EN 1822 standarda



Filtration stage	Type and description	Filter dimensions mm	Efficiency
<b>A</b>	 Metal pre-filter	22	G2
<b>B</b>	 Semi-rigid pocket filter	380	F9 95%

# ABF

DOWNDRAFT BENCH WITH FILTRATION

## DIMENSIONAL DATA

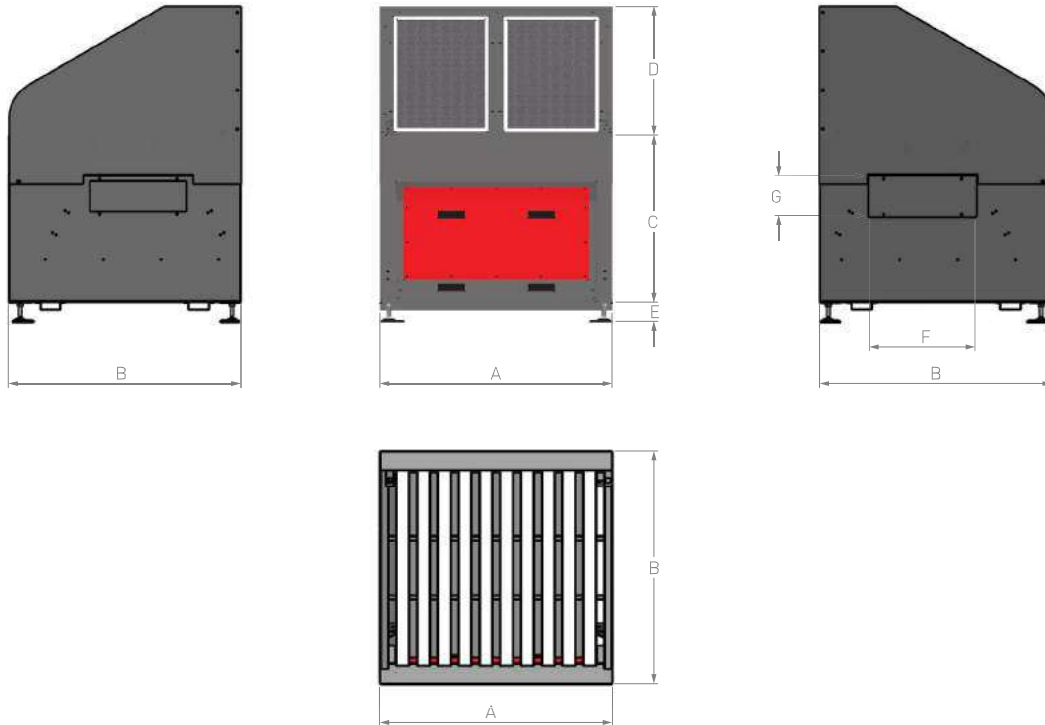

Model	A mm	B mm	C mm	D mm	E		F mm	G mm
					Min. mm	Max. mm		
ABF 10	1000	1200	860	665	20	140	500	160
ABF 15	1500	1200	860	665	20	140	500	160
ABF 20	2000	1200	860	665	20	140	500	160
ABF 30	3000	1200	860	665	20	140	500	160

## TECHNICAL FEATURES

Model	Dimensions WxD mm	Extractor capacity m <sup>3</sup> /h	Pressure drop Pa	Filtering area m <sup>2</sup>	Pre-filter efficiency %	Total weight kg
ABF 10	1000x1200	4000	600	8,1	F9 95%	90
ABF 15	1500x1200	5300	600	10,8	F9 95%	110
ABF 20	2000x1200	6650	600	13,5	F9 95%	130
ABF 30	3000x1200	8000	600	16,2	F9 95%	180

The performance data were detected in our laboratories, using appropriate equipment.

The air flow rates and pressure drop parameters were recorded under normal conditions of use, considering the parameters required by the current Standards and the state of the art.

## DESCRIPTION



ABF downdraft bench	Code	Description
	ABF010000GA0	Downdraft bench ABF 10 - Pre-filter efficiency M6 - L. 1000 mm - Painted steel - Grey/red
	ABF015000GA0	Downdraft bench ABF 15 - Pre-filter efficiency M6 - L. 1500 mm - Painted steel - Grey/red
	ABF020000GA0	Downdraft bench ABF 20 - Pre-filter efficiency M6 - L. 2000 mm - Painted steel - Grey/red
	ABF030000GA0	Downdraft bench ABF 30 - Pre-filter efficiency M6 - L. 3000 mm - Painted steel - Grey/red

## ACCESSORIES

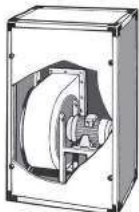
### EXTRACTOR FAN

Extractor fan	Codice	Descrizione
	BLUVRP35050001	Backward curved extractor fan RP 350 for ABF 10 and ABF 15 - 3kW 400V - Maximum flow rate 7650 m <sup>3</sup> /h - Sound-proof enclosure
	BLUVRP40060001	Backward curved extractor fan RP 400 for ABF 20 and ABF 30 - 4kW 400V - Maximum flow rate 9500 m <sup>3</sup> /h - Sound-proof enclosure

### SWITCHES AND ELECTRICAL PANELS

Switches and electrical panels	Code	Description
	QEINT32A4P000	Switch disconnecter 32A IP66 lockable, 125x150hx93 mm
	QE4003F075KW0	Three-phase 4-pole switchboard 400V 50/60Hz 0,55-7,5kW 15A IP55 lockable, 240x340hx170 mm 5,5 kg. Functions: thermal magnetic protection, self-setting based on connected motors, remote start/stop in centralized system, voltage / current / cosΦ / alarms display, multilingual display, phase sequence alarm for motor rotation

# ABF

DOWNDRAFT BENCH WITH FILTRATION

## SPARE PARTS

### FILTERS

Replacement filters for ABF	Code	Description
	RF0ABF000000	Replacement filter set for bench ABF 10 including: spark arrestor, pocket filters
	RF0ABF000001	Replacement filter set for bench ABF 15 including: spark arrestor, pocket filters
	RF0ABF000002	Replacement filter set for bench ABF 20 including: spark arrestor, pocket filters
	RF0ABF000003	Replacement filter set for bench ABF 30 including: spark arrestor, pocket filters